

Damper actuator for operating air control dampers in ventilation and air-conditioning systems for building services installations

- Torque: 10Nm
- Nominal voltage: AC 24...240V / DC 24...125V
- Control: Open/Close



Technical data

Electrical data		Nominal voltage	AC 24...240V 50/60Hz, DC 24...125V
		Nominal voltage range	AC 19.2...264V / DC 21.6...137.5V
		Power consumption	6W @ nominal torque / 2.5W @ holding
		For transformer sizing	6VA @ AC 24V; 6.5VA @ AC 120V; 9.5VA @ AC 240V
		Connecting cable	Cable 1m, 2x0.75mm ²
Functional data		Torque	10Nm @ nominal voltage
		Direction of rotation	Selectable by mounting L/R
		Manual override	By manual override key
		Angle of rotation	Max. 95°, adjustable by mechanical stops
		Running time	-motor 75s -spring return 20s @ -20...+50°C / max. 60s @ -30°C
		Sound power level	-motor Max. 45dB(A) -spring return Max. 62dB(A)
		Position indicator	Mechanical
Working conditions		Protection class	II (Totally insulated)
		Degree of protection	IP54
		EMC	CE according to 2004/108/EC
		Low voltage directive	CE according to 2006/95/EC
		Mode of operation	Type 1.AA (EN 60730-1)
		Ambient temp.	-30...+50°C
		Non-operation temp.	-40...+80°C
		Humidity	5...95% RH, non-condensing
		Maintenance	Maintenance-free
Dimensions / weight		Dimensions (LxWxH)	See "Dimensions"
		Weight	2kg

Dimensions [mm]

Standard :
¾"-clamp (with insert)

Damper shaft	Length	● I	■ I	◊ I
	≥85	10...22	10	14...25.4
	≥15	10...22	10	14...25.4

Optional 1:
1"-clamp (without insert)

Damper shaft	Length	● I	■ I
	≥85	19...25.4	12...18
	≥15	19...25.4	12...18

Optional 2:
½"-clamp (optional via configuration)

Damper shaft	Length	● I	■ I	◊ I
	≥85	10...19	—	14...20
	≥15	10...19	—	14...20

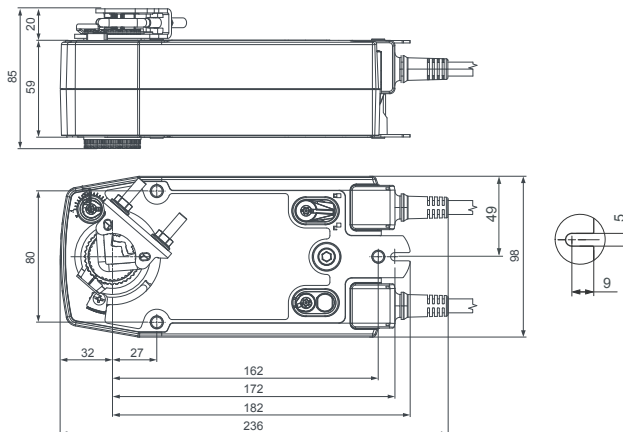

Damper actuator for operating air control dampers in ventilation and air-conditioning systems for building services installations

- Torque: 10Nm
- Nominal voltage: AC 24...240V / DC 24...125V
- Control: Open/Close
- 2xSPDT auxiliary switches



Technical data

Electrical data			
Nominal voltage		AC 24...240V 50/60Hz, DC 24...125V	
Nominal voltage range		AC 19.2...264V / DC 21.6...137.5V	
Power consumption		6W @ nominal torque / 2.5W @ holding	
For transformer sizing		6VA @ AC 24V; 6.5VA @ AC 120V; 9.5VA @ AC 240V	
Auxiliary switch (-S2)		2 SPDT, 1mA...3(0.5)A, AC 250V one fixed at 10%, one adjustable 10...90%	
Connecting cable -motor		Cable 1m, 2x0.75mm ²	
-auxiliary switch (-S2)		Cable 1m, 6x0.75mm ²	
Functional data			
Torque		10Nm @ nominal voltage	
Direction of rotation		Selectable by mounting L/R	
Manual override		By manual override key	
Angle of rotation		Max. 95°, adjustable by mechanical stops	
Running time -motor		75s	
-spring return		20s @ -20...+50°C / max. 60s @ -30°C	
Sound power level -motor		Max. 45dB(A)	
-spring return		Max. 62dB(A)	
Position indicator		Mechanical	
Protection class		II (Totally insulated)	
Degree of protection		IP54	
EMC		CE according to 2004/108/EC	
Low voltage directive		CE according to 2006/95/EC	
Mode of operation		Type 1.AA.B (EN 60730-1)	
Ambient temp.		-30...+50°C	
Non-operation temp.		-40...+80°C	
Humidity		5...95% RH, non-condensing	
Maintenance		Maintenance-free	
Dimensions / weight			
Dimensions (LxWxH)		See "Dimensions"	
Weight		2.2kg	

Dimensions [mm]

Standard :

¾"-clamp (with insert)

Damper shaft	Length	● I	■ I	◆ I
	≥85	10...22	10	14...25.4
	≥15	10...22	10	14...25.4

Optional 1:

1"-clamp (without insert)

Damper shaft	Length	● I	■ I
	≥85	19...25.4	12...18
	≥15	19...25.4	12...18

Optional 2:

½"-clamp (optional via configuration)

Damper shaft	Length	● I	■ I	◆ I
	≥85	10...19	—	14...20
	≥15	10...19	—	14...20

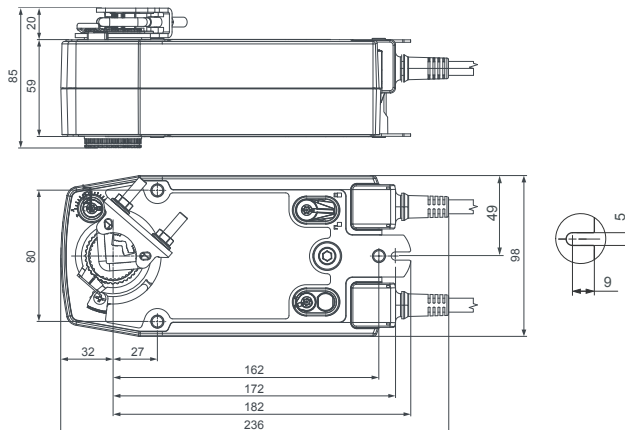

Damper actuator for operating air control dampers in ventilation and air-conditioning systems for building services installations

- Torque: 10Nm
- Nominal voltage: AC/DC 24V
- Control signal: DC (0)2...10V
- Position feedback: DC 2...10V



Technical data

Electrical data		Nominal voltage		AC 24V 50/60Hz, DC 24V
		Nominal voltage range		AC 19.2...28.8V / DC 21.6...28.8V
		Power consumption		3.5W @ nominal torque / 2.5W @ holding
		For transformer sizing		6VA
		Connecting cable		Cable 1m, 4x0.75mm ²
Functional data		Torque		10Nm @ nominal voltage
		Control signal Y		DC (0)2...10V @ input impedance 100kΩ
		Position feedback signal U		DC 2...10V @ max. 0.5mA
		Position accuracy		±5%
		Direction of rotation		Reversible with switch Selectable by mounting L/R
		Manual override		By manual override key
		Angle of rotation		Max. 95°, adjustable by mechanical stops
		Running time		-motor 150s -spring return 20s @ -20...+50°C / max. 60s @ -30°C
		Sound power level		-motor Max. 40dB(A) -spring return Max. 62dB(A)
		Position indicator		Mechanical
Working conditions		Protection class		III (safety extra-low voltage)
		Degree of protection		IP54
		EMC		CE according to 2004/108/EC
		Mode of operation		Type 1.AA (EN 60730-1)
		Ambient temp.		-30...+50°C
		Non-operation temp.		-40...+80°C
		Humidity		5...95% RH, non-condensing
		Maintenance		Maintenance-free
Dimensions / weight		Dimensions (LxWxH)		See "Dimensions"
		Weight		2kg

Dimensions [mm]

Standard :
¾"-clamp (with insert)

Damper shaft	Length			
	≥85	10...22	10	14...25.4
	≥15	10...22	10	14...25.4

Optional 1:
1"-clamp (without insert)

Damper shaft	Length		
	≥85	19...25.4	12...18
	≥15	19...25.4	12...18

Optional 2:
½"-clamp (optional via configuration)

Damper shaft	Length			
	≥85	10...19	—	14...20
	≥15	10...19	—	14...20

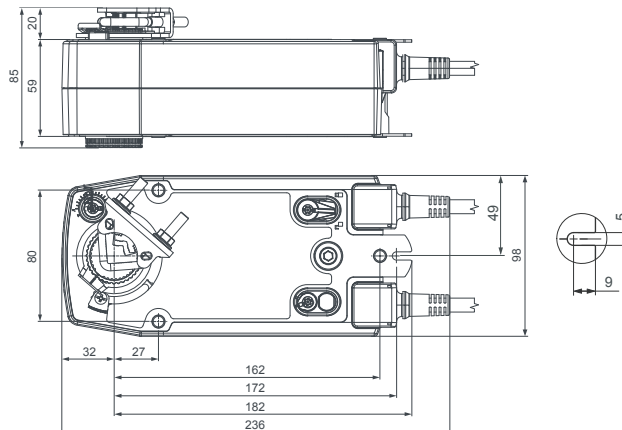

Wiring diagrams

Modulating control

Notes:

- Connection via safety isolating transformer.
- Parallel connection of several actuators is possible.
- Power consumption must be observed.

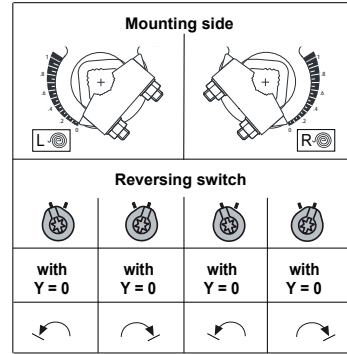
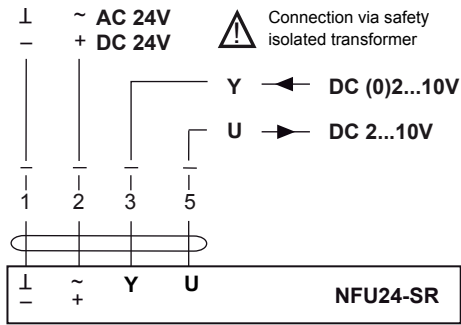

Open/Close control

Notes:

- Parallel connection of several actuators is possible.
- Power consumption must be observed.

